

## Overview

For low-voltage, low-cost, industrial/commercial applications requiring long-life.

### 59 Series

Snap fit for 3/4" (19) hole. Flat white button center prevents accidental operation. High amperage momentary models.

### 250

Ideal for simultaneous operation of two or three devices from one central point. Fully insulated. Normally open. Multiple contact model.

### 255

Where breaking of one circuit and making another is required or closed circuit. Fully insulated.

### 620 Series

Available in polished chrome, nickel or brass. Low cost, high reliability. Heavy-duty construction for long-life (above 100,000 operations at rated load). Insulated for mounting on metal cabinets. Large terminal screws. Available with illuminated center for use in unlighted areas.

## Standard Features

- AC or DC up to 50 Volts
- Fits 3/4" or 5/8" diameter hole
- Panel mounted
- N.O. momentary push

## 250 & 255 Contact Arrangement

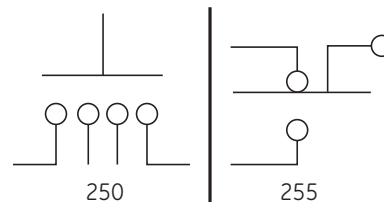

## Ordering Information

Cat. No.	Type	Volts	AC Amps	DC Amps	Finish		Hole Size inches (mm)	Hole Depth inches (mm)
					Rim	Center		
59	Snap fit	12	8.0	8.0	Polished nickel	White	3/4 (19)	11/16 (17)
		24	6.0	4.0				
		48	3.0	2.0				
250	Snap fit Multiple Contact	12	6.0	2.0	Polished nickel	Black	3/4 (19)	11/16 (17)
255	Snap fit SPDT	24	4.0	1.0				
		48	2.0	0.5				
620	Snap Fit	8	2.0	2.0	Chrome	Ivory	5/8 (16)	3/4 (19)
620-B		24	0.67	0.5	Brass			
		48	0.3	0.3				
620-L	Snap Fit	6	2.0	2.0	Chrome	Lighted Ivory		
620-LB		16	1.0	1.0	Brass			

## Low Voltage Pushbuttons

59, 250 and 620 Series



59

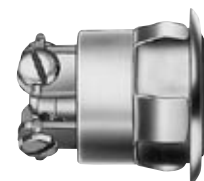

250



620

