



BarnGuard LED

Barn Lights



Catalog
Number

Notes

Type

Hit the Tab key or mouse over the page to see all interactive elements.

Specifications

Width: 9-1/2"
(24.0 cm)

Height: 9-1/8"
(23.0 cm)

Depth: 11-3/8"
(29.0 cm)

Weight: 4.8 lbs.
(2.17 kg)

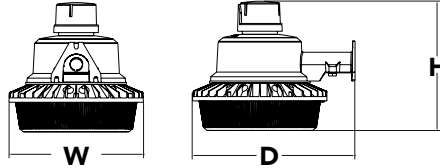

Backplate

Width: 2-3/4"
(7 cm)

Height: 2-1/4"
(5.6 cm)

Opening: 1-3/4"
(4.5 cm)

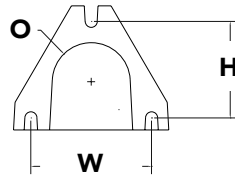

Introduction

BarnGuard LED security lights combine a classic dayform with LED technology, ideal for upgrading the massive install base of mercury vapor or high pressure sodium (HPS) luminaires.

The BarnGuard LED security lights feature high quality white light that makes them ideal for replacing the yellow light of HPS. And with up to 7,900 lumens there is enough light to replace up to 175W Mercury Vapor luminaires while saving up to 80% in energy costs. With an expected service life of over 10 years, the BarnGuard LED is a true maintenance-free solution.

Ordering Information

EXAMPLE: BGR LED P2 40K MVOLT PER DNA

Luminaire	Lumen Output	Power Input	Efficacy (Lumens per Watt)	Color Temperature	Voltage	Controls	Finish	Catalog Number	CI Code	UPC Code
BGR LED	4,700	36W	130	4000K	MVOLT (120V - 277V)	Twist-lock replaceable photocell	Grey	BGR LED P1 40K MVOLT PER DNA	*2679X3	194994252542
	7,900	56W	141	4000K				BGR LED P2 40K MVOLT PER DNA	*2679X4	194994252559
				5000K				BGR LED P2 50K MVOLT PER DNA	*2679X5	194994252573

Accessories

Ordered and shipped separately.

OMA Mounting Arm

CI Code *136XUY

UPC Code 00745973700907

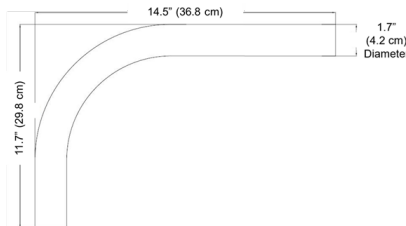

OMA Mounting Arm
(Optional)

FEATURES & SPECIFICATIONS

INTENDED USE

The energy savings, long life and easy-to-install design of the BGR LED make it the smart choice for street and alleyway lighting, farms, and building-or-post-mounted doorway, pathway and yard illumination for any commercial or residential facility. Use the BGR P1 for best energy savings and the BGR P2 for maximum illumination. MVOLT (120V-277V) input for both residential and commercial applications. Rated for operation up to 40°C (104°F) ambient temperature.

CONSTRUCTION

Die-cast aluminum housing with an impact-resistant, polycarbonate lens. The luminaire is sealed against moisture and environmental contaminants.

FINISH

Exterior parts are protected by a powder-coat, natural aluminum-colored paint finish for superior resistance to weathering.

OPTICS

Removable lower diffuser provides some up-light for a traditional appearance and reduces discomfort glare. DesignLights Consortium® (DLC) qualified with or without diffuser. 80 min. CRI for BGR LED P1 and 70 min. CRI for BGR LED P2.

ELECTRICAL

Energy-efficient LEDs are mounted on the integral aluminum heat sink to maximize heat dissipation and promote long LED life (L70/100,000 hours at 25° C). 6kV surge protection. Twistlock, replaceable, MVOLT (120V-277V) photocell is standard equipment.

INSTALLATION

Mounts directly to wooden posts or poles using (3) 2" lag bolts (included) or can be used with an existing 1-5/8" mounting arm. Can also be installed using the Lithonia Lighting OMA mounting arm (sold separately).

LISTINGS

DesignLights Consortium® (DLC) qualified product. Not all versions of this product may be DLC qualified. Please check the DLC Qualified Products List at www.designlights.org/QPL to confirm which versions are qualified.

WARRANTY

Five-year limited warranty. Complete warranty terms located at: www.acuitybrands.com/CustomerResources/Terms_and_conditions.aspx.

Note: Actual performance may differ as a result of end-user environment and application. All values are design or typical values, measured under laboratory conditions at 25 °C. Specifications subject to change without notice.



COMMERCIAL OUTDOOR

One Lithonia Way • Conyers, Georgia 30012 • Phone: 1-800-705-SERV (7378) • www.lithonia.com
© 2020 Acuity Brands Lighting, Inc. All rights reserved.

BarnGuard
Rev. 08/13/20

Performance Data

Electrical Load

Luminaire	Input Power (W)	Electrical Load			
		Current (A)			
		120V	208V	240V	277V
BGR LED P1	36W	0.32	0.18	0.16	0.14
BGR LED P2	56W	0.47	0.27	0.23	0.20

Photometric Diagrams

To see complete photometric reports or download .ies files for this product, visit the Lithonia Lighting Outdoor [BGR LED](#) homepage. Tested in accordance with IESNA LM-79 and LM-80 standards.

LEGEND

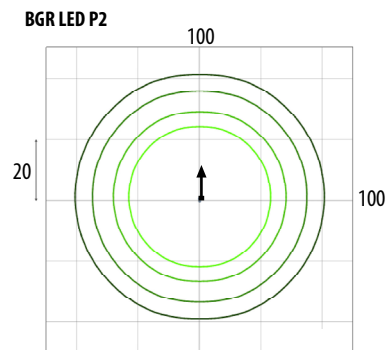
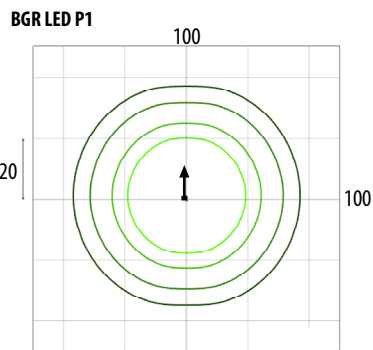
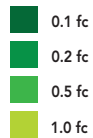

Mounting Height: 15ft